

REVISIONS				
ZONE	REV.	DESCRIPTION	DATE	APPROVED
	A	REVISED TO PRODUCTION AND SHOWED THE MIN AND MAX DISTANCE FOR SLOTS	10/23/2009	C.C.

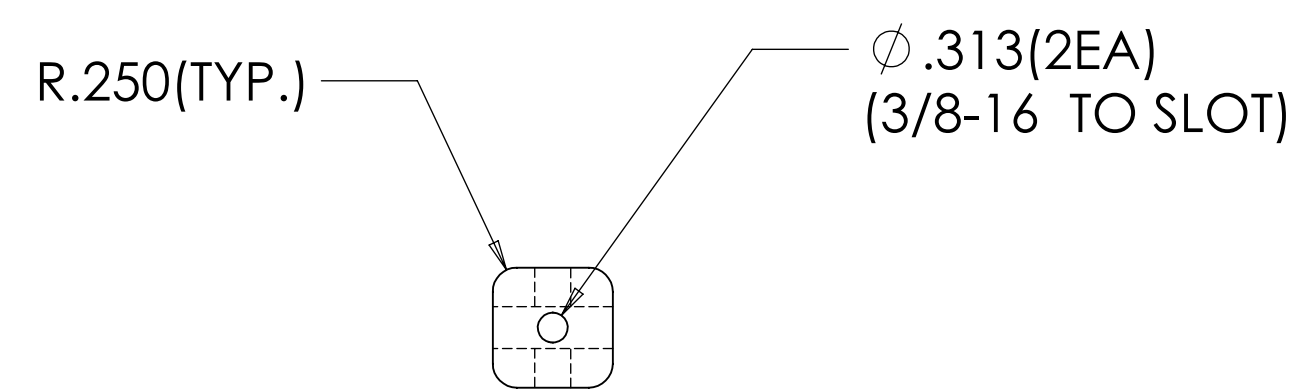
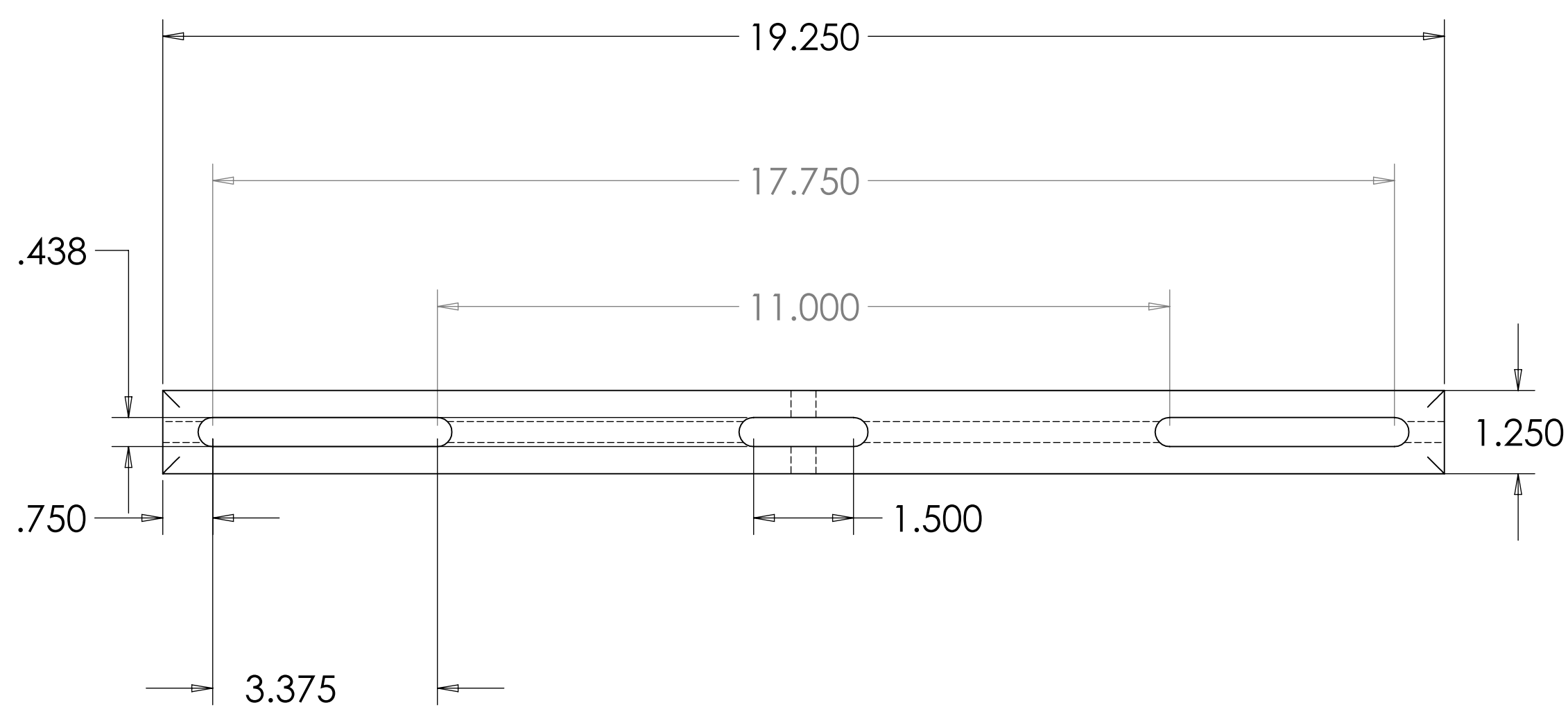
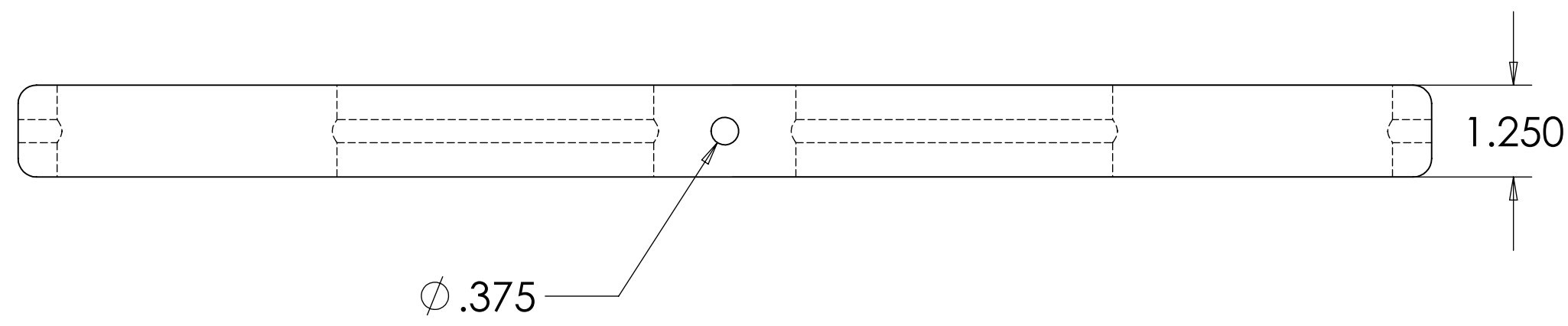
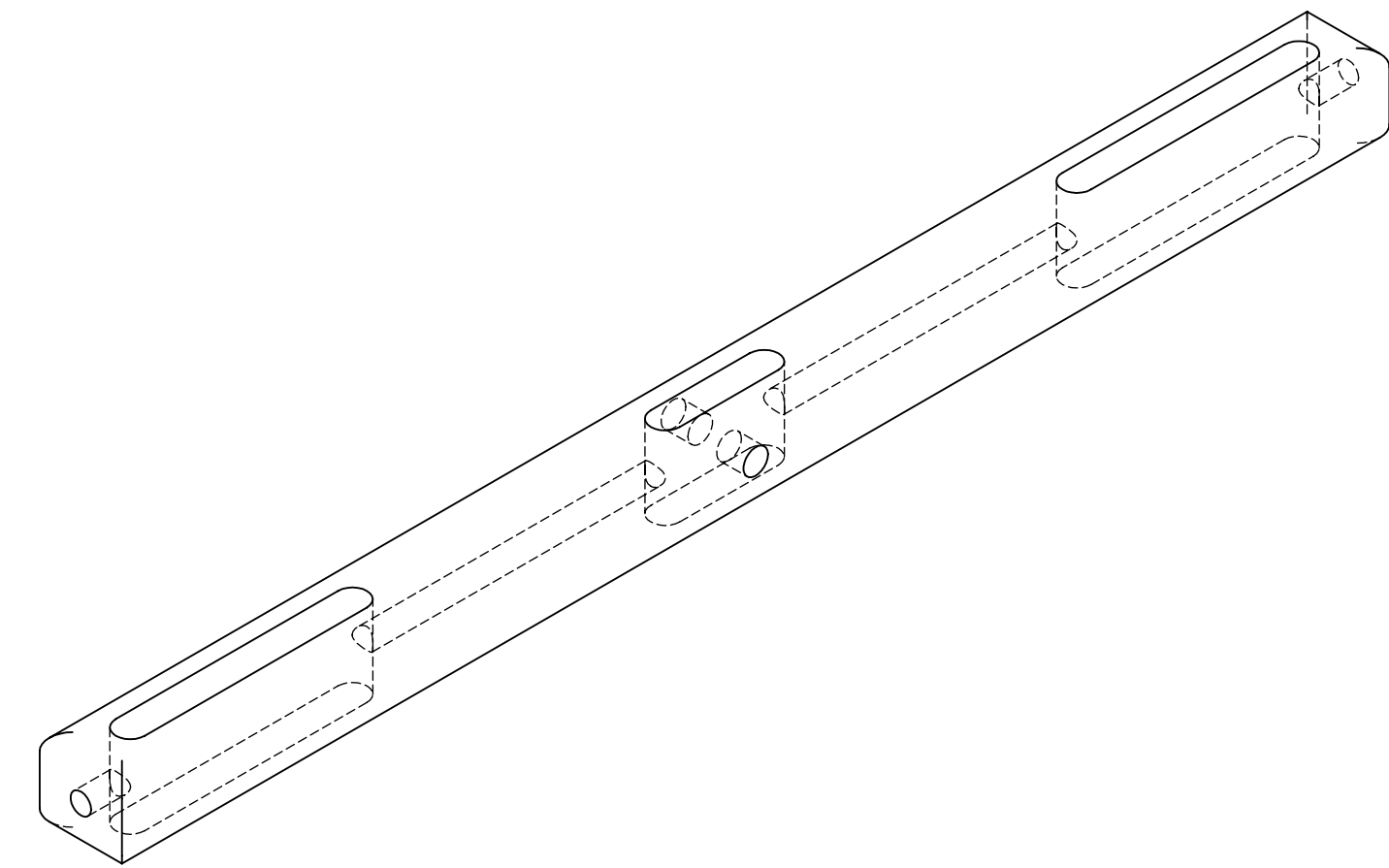

PROPRIETARY AND CONFIDENTIAL
 THE INFORMATION CONTAINED IN THIS DRAWING IS THE SOLE PROPERTY OF AZTECH CONVERTING SYSTEMS INC. ANY REPRODUCTION IN PART OR AS A WHOLE WITHOUT THE WRITTEN PERMISSION OF AZTECH MACHINERY INC. IS PROHIBITED.

STOCK SIZE		UNLESS OTHERWISE SPECIFIED:		TITLE:	
1-1/4 X 1-1/4 X 25-1/16		DIMENSIONS ARE IN INCHES TOLERANCES: FRACTIONAL $\pm 1/16$ ANGULAR: MACH ± 1 BEND \pm TWO PLACE DECIMAL $\pm .01$ THREE PLACE DECIMAL $\pm .005$		DIE LIFT BAR, 19"	
		INTERPRET GEOMETRIC TOLERANCING PER:		DRAWN C.CHURCHILL 7/14/2004	
		MATERIAL		ENG APPR.	
		6061-T6		Q.A.	
NEXT ASSY		USED ON		COMMENTS:	
		FINISH		SCALE: 1:2	
		HEAT SHRINK TUBE WRAP		DWG. NO. 13252	
APPLICATION		DO NOT SCALE DRAWING		REV A	
				WEIGHT 2.251	
				SHEET 1 OF 1	