

## SAFETY REMINDERS & OTHER USEFUL TIPS

1. This machine is not a toy, therefore children should not be allowed to operate it.
2. Make sure your **OptiCombo-341** is placed on top of a sturdy surface before use & that the electrical chord is securely attached to a wall outlet (110V).
3. Keep hair, fingers, jewelry and all loose clothing away from all moving parts of your **OptiCombo-341** as they may accidentally be pulled into the machine causing damage to it or worse, injury to the user.
4. Never operate your machine near water or any type of liquid to reduce the risk of electric shock.
5. Periodically check the electrical chord of your **OptiCombo-341** for any visible sign of damage and avoid using it when it is present.
6. Use a test sheet to punch to determine if there will be any holes running off the sides and disengage the appropriate pins.
7. Do not punch more than 20 sheets of 20lb. paper when punching. Preferably, punch no more than 12-15 sheets at a time to help extend the life of your **OptiCombo-341**.
8. When punching on PVC or PP covers, it is recommended that you punch at a maximum of 2 sheets at a time.
9. Periodically check and empty the waste drawer. An overfilled waste drawer may damage the machine when punching.
10. Protect your **OptiCombo-341** keeping it from the elements such as water or excessive heat.
11. Your **OptiCombo-341** should not be used other than its intended purpose and function.
12. Always call the authorized dealer first for technical issues or any malfunction. Trying to fix the machine by yourself might not only be dangerous, but may also void the warranty.

## WARRANTY INFORMATION

Our machines are guaranteed against defects in materials and workmanship for a period of one year from the date of original purchase from an authorized dealer of TAMERICA PRODUCTS, INC. If you perceive or experience any issue with the machine, kindly report it to the dealer within 10 business days of said purchase to avail of free pickup and redelivery from TAMERICA's Service Center. After the first 10 days, you will either receive service instructions and parts via mail free of charge for the duration of the warranty.

Note that when returning the machine for warranty claims, the machine should be returned in its complete original packaging to avoid incidental or consequential damages that may void the claim. A copy of the invoice or other proof of purchase also needs to be sent with the machine.

Upon evaluation of the machine and the determination of the actual defect, the machine will be restored to its regular working condition by the Service Center and shipped back to you free of charge. If you change your mind and simply want to return the machine, a 20% restocking fee is charged even within the 10-day grace period. Further, you will have to cover freight to return the machine and it has to be in brand-new resalable condition, otherwise, you might incur more charges.

**This warranty covers all defects incurred in the normal use of the equipment except in the following cases:**

- Loss or damage to the equipment due to improper operation, abuse, mishandling or failure to follow the operating instructions.
- Removal or alteration of the serial number.
- The machine being serviced or modified by anyone other than a certified technician authorized by TAMERICA.

***This warranty is valid only within the Contiguous USA, Alaska and Hawaii excluded.***



**TAMERICA**  
PRODUCTS, INC.

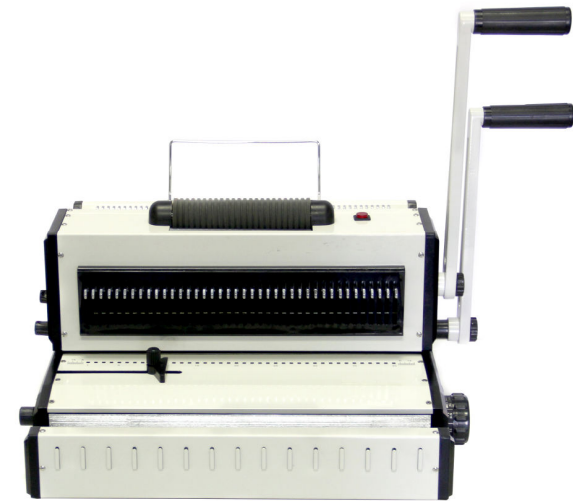

## OPTICOMBO-341

Wire 3:1 and Coil 4:1 Binding Machine

## **IMPORTANT !!!**

**It will be beneficial to first get yourself acquainted with the features of your OptiCombo-341 before attempting to use. Keep in mind all operational instructions, tips, and safety reminders every time you use your OptiCombo-341 to best achieve desirable results.**

## FEATURES

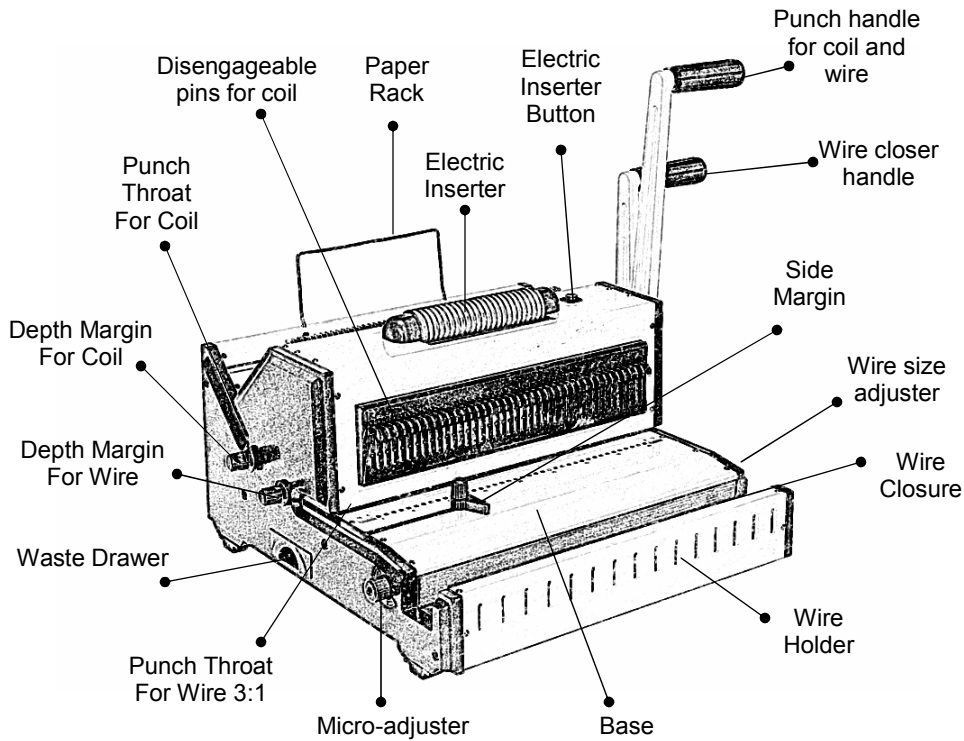

## PUNCHING

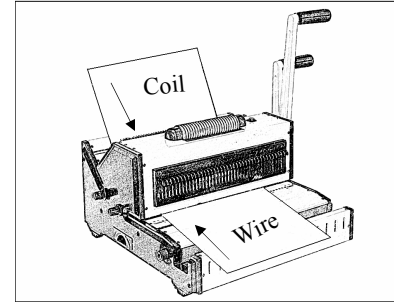

1. Place your document on the punch throat for coil or wire. Adjust side margin guides according to size of document and / or ruler guide.
2. Disengage pins that would punch off the edge of the document.
3. Pull down the punch handle and then bring back up.

## BINDING FOR WIRE

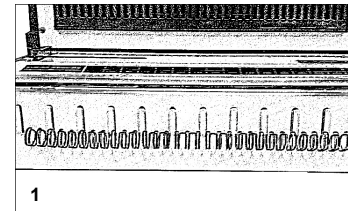

1. Select the right wire size according to document thickness and hang on the wire holder.
2. Insert paper into the wire.
3. Put paper with wire into closing unit and select the size of wire on the wire size adjuster.
4. Pull down the wire closer handle to bind the document.

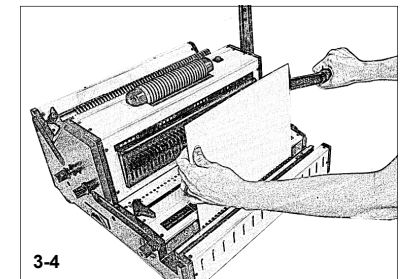
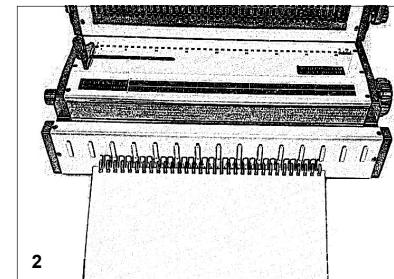

## SPECIFICATIONS

- Punch type: Coil 4:1 and 3:1 wire
- Punch method: Manual
- Max. punching capacity: 20 sheets
- Max. binding capacity for wire: 120 sheets
- Max. binding capacity for coil: 220 sheets
- Max. punching length: A3
- Paper load: Horizontal
- Usage: Moderate
- Disengageable pins: Yes
- Punch depth control: Adjustable
- Edge guide: Yes
- Binder: Coil inserter and wire closer
- Net weight: 55lbs
- Gross weight: 60 lbs
- Shipping dims: 23" x 21" x 15"
- Warranty: 1 year

## BINDING FOR COIL

1. Align the document and manually insert the coil into the first 4 to 5 holes as shown.
2. Press the electric inserter button and gently press the coil against the inserting roller.
3. Use the handheld coil crimping pliers to crimp the ends to keep the document from unbinding.

